

Hilgeland  
Kieserling  
EWMenn  
Nutap

Nut Tapper MAS F  
Brand NUTAP



MAS



# MAS

The nut tapper MAS F with double spindle is based on the well proven bent shank tap technology as well as on the advantage of modern drive and control technologies.

- Simple operation and quick change of tooling for different part configurations and pitch sizes
- Ease of use through stored memory adjustments (recallable data)
- Double-shaft guidance for the toolholder guarantees optimal perpendicularity (TIR) and tight thread tolerances
- A round nut clamping system is also available
- 100% control with tap monitoring system possible

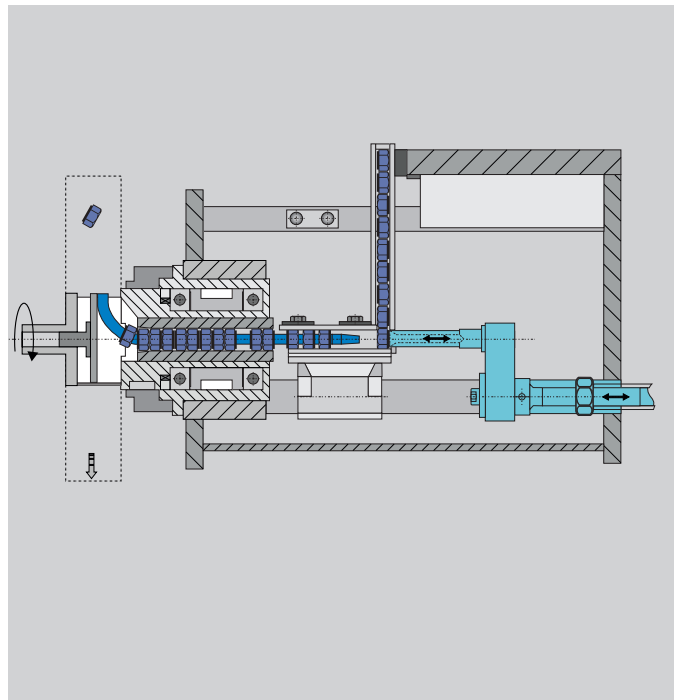

▲ Tool arrangement

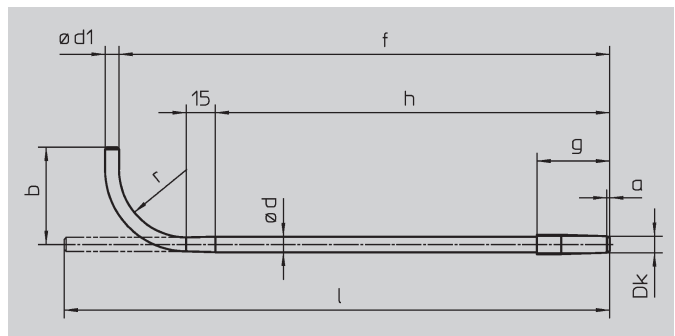

▲ Bent shank tap

# Nut Tapper MAS F

## Brand NUTAP



<b>Technical Data</b>		<b>MAS 14 F</b>	<b>MAS 33 F</b>
Number of spindles		2	2
Size range metric		M5 – M14	M12 – M33
Size range inch		¼" – ½"	½" – 1¼"
Outside diameter	max. mm	30	58
A/F square	max. mm	21	40
A/F hex.	max. mm	24	50
A/F octagonal	max. mm	27	48
Power of spindle motor	kW	5.5	7.5 (11)
Variable speed	1/min	450 – 4100	200 – 1800
Output (standard hex. nut)	max. pcs/min.*	300	120
Coolant tank capacity	l	230	380
Over-all-dimensions (L x W x H)	mm	1800 x 1000 x 2030	2500 x 1400 x 2300
Machine weight	approx. kg	1900	4000

\*) The output depends on material and product.



Hilgeland  
Kieserling  
EWMenn  
Nutap



**WAFIOS**  
**Umformtechnik GmbH**

Precision Parts  
Forming Machinery

**Made in Germany**

Im Rehsiepen 35, 42369 Wuppertal  
Phone +49 (202) 46 68-0  
Fax +49 (202) 46 68-225

[sales@wafios-umformtechnik.de](mailto:sales@wafios-umformtechnik.de)  
[www.wafios-umformtechnik.com](http://www.wafios-umformtechnik.com)  
Germany

The specifications are not binding as  
these could vary on account of technical  
developments.

06.2024